



RIGID RAIL PANEL FASTENERS

DESIGNED ESPECIALLY FOR WOOD, HIGH DENSITY FOAM OR METAL FRAME RAILS

This series of Keil™ brand panel fasteners is designed for use with wood, high density foam or metal frame rail insulated panels. This economical method of producing pre-fabricated insulated panels permits the manufacturer to build panel sections of virtually any size or shape.

We offer a wide array of rigid rail locking points, strikes and pins, which may be combined to accommodate a broad range of panel thicknesses, joint types and rail materials.

ADDED VALUE

Unlike competing models, Our Keil brand of rigid rail panel fasteners are FULLY constructed of heavy-gauged steel, including our unique friction drive cam system for unsurpassed strength and locking ability. These unique cams prevent stripping of the hex points when locking or unlocking panels. This minimizes issues with on-site installations and eliminates the need to scrap panels because of stripped-out fasteners that no longer work.

THE KEIL™ DIFFERENCE

Keil™ Refrigeration Hardware is known for innovative design, exceptional value and unsurpassed quality. Our products are manufactured to our exacting standards to insure they can withstand the rigorous demands required in commercial refrigeration applications.

We know that panel fasteners are the “glue” that holds your walk-in cooler/freezer together. If they do not function properly, it can result in increased energy consumption or failure of the structural integrity of the entire unit. That’s why all of our panel fasteners undergo rigorous quality inspections to insure our customers of the durability and reliability they have come to know and trust from the Keil™ brand.

The next time you are building or specifying a walk-in cooler, freezer or environmental enclosure, be sure that it is made using authentic Keil™ brand refrigeration hardware for trouble-free performance and peace of mind.

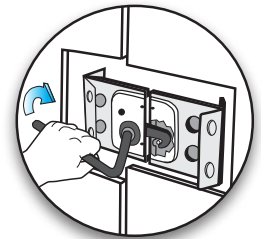

Use CHG Model No. W27-0001-C hexagonal wrench for easy locking of all CHG panel fasteners.

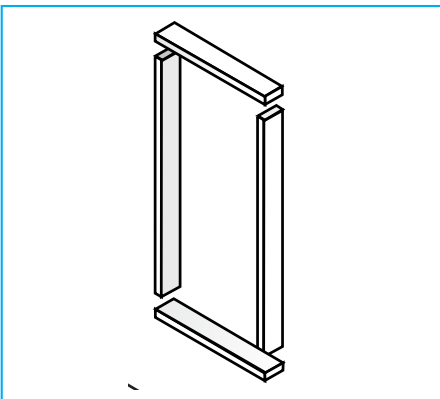

1. Cut frame material to form panel perimeter.

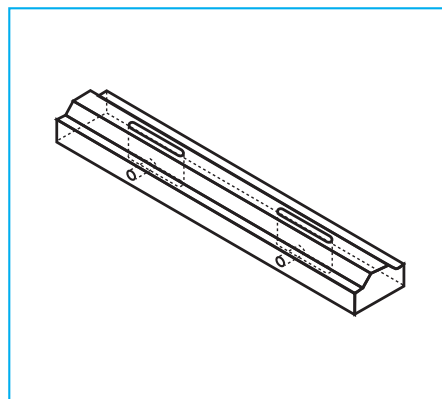

2. Determine locations for fasteners and mortise, dado, or rout slots. Drill wrench holes. (If using W27-5501/5502, drill pin holes.)

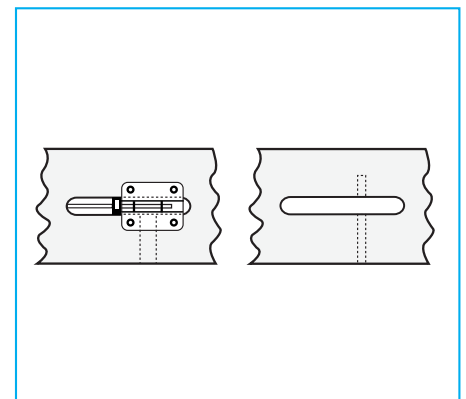

3a. Place fastener in slot and nail or staple in place.
3b. If using W27-5501/5502 pin, insert in drilled pin holes. (Taping of back may be required when foaming.)

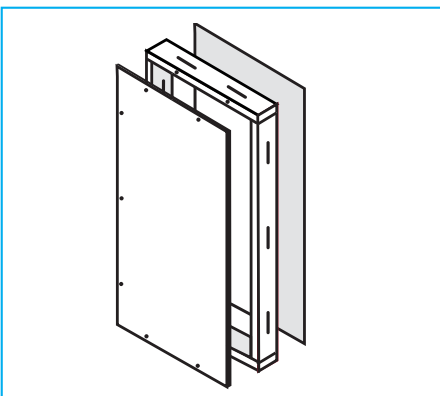

4. Assemble frame with panel skins.

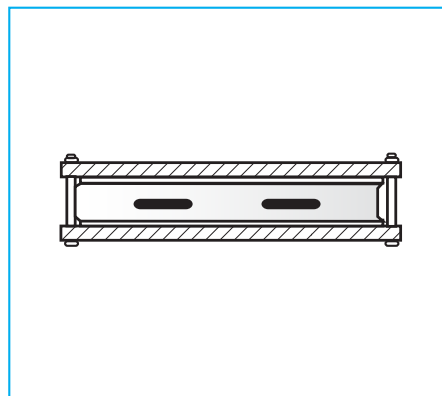

5. Clamp panel in restraining fixture and inject foam.

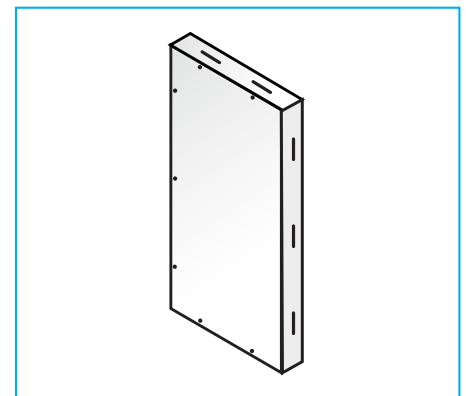

6. The finished panels are ready for fast, easy joining using W27-0001-C wrench.