

PROJECT NAME: _____

LOCATION: _____

SPECIFIER ITEM NO. _____ **QTY:** _____

ENCORE PART NO. _____

Encore® Wok Faucet with Swing Spout and
 6" (152mm) Wrist Blade Handle

KL76-90xx-SE6 Series

- KL76-9006-SE6 6" Spout
- KL76-9008-SE6 8" Spout
- KL76-9010-SE6 10" Spout
- KL76-9012-SE6 12" Spout
- KL76-9014-SE6 14" Spout
- KL76-9016-SE6 16" Spout

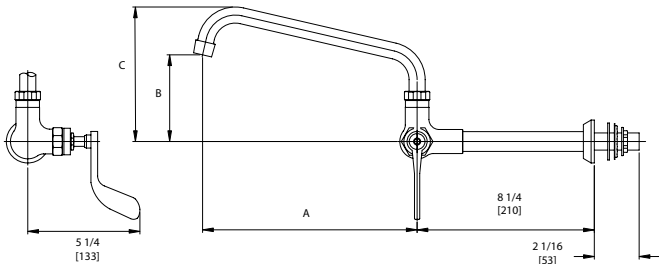

Dimensions shown in inches (mm) are for reference only and are subject to change.

1-1/8" (29mm) hole for backsplash is recommended to accommodate 1/2" supply nipple
 1/2" NPS Inlet
 Operating Temperature: 40-180°F (5-83°C)
 Operating Pressure: 15-125psi

Approximate shipping weight - 4 lbs
 Warranty - 2 years parts

Solid heavy duty cast body is specification and commercial quality

Commercial Quality Features

- Tubular swing spout design
- ADA-compliant 6" (152mm) wrist blade handle
- Leak proof double O-ring spout design
- Stainless steel spout

SPECIFICATIONS:

Wall Mount Spout Base to be Encore KL76 Series in the following configuration:

- _____ KL76-9006-SE6 6" Spout
- _____ KL76-9008-SE6 8" Spout
- _____ KL76-9010-SE6 10" Spout,
- _____ KL76-9012-SE6 12" Spout
- _____ KL76-9014-SE6 14" Spout
- _____ KL76-9016-SE6 16" Spout

Wok faucet body to be constructed of polished chrome plated brass with 6" (152mm) wrist blade handle. Valve to be 1/4-turn with integral check valve to prevent cross-flow and back-flow. Spout to be stainless steel tubular swing style with leak proof double O-ring seal design. 2.2gpm aerator @ 60psi standard with full flow stream bubbler screen spout tip.

Model No.	A	B	C
KL76-9006-SE6	6" (152mm)	3-1/8" (79mm)	5-3/8" (136mm)
KL76-9008-SE6	8" (203mm)	3-5/8" (91mm)	5-13/16" (147mm)
KL76-9010-SE6	10" (254mm)	4-1/16" (103mm)	6-5/16" (160mm)
KL76-9012-SE6	12" (305mm)	4-1/2" (114mm)	6-3/4" (171mm)
KL76-9014-SE6	14" (356mm)	5" (126mm)	7-3/16" (183mm)
KL76-9016-SE6	16" (406mm)	5-7/16" (138mm)	7-5/8" (194mm)

COMPLIES WITH:
 THE FEDERAL "REDUCTION OF LEAD
 IN DRINKING WATER ACT" -
 2011 - US SENATE BILL NO. S.3874
 NSF/ANSI 61/9, ANNEX G

