

PROJECT NAME: _____

LOCATION: _____

SPECIFIER ITEM NO. _____ **QTY:** _____

ENCORE PART NO. _____

Encore[®] 4" (102mm) Wall Mount Faucet with Rigid Gooseneck Spout and 4" (102mm) Wrist Blade Handles

KL45-4x0x-RE4 Series

- KL45-4100-RE4 3" Spout, Ceramic Valves
- KL45-4000-RE4 3" Spout, Compression Valves
- KL45-4102-RE4 6" Spout, Ceramic Valves
- KL45-4002-RE4 6" Spout, Compression Valves
- KL45-4101-RE4 8" Spout, Ceramic Valves
- KL45-4001-RE4 8" Spout, Compression Valves

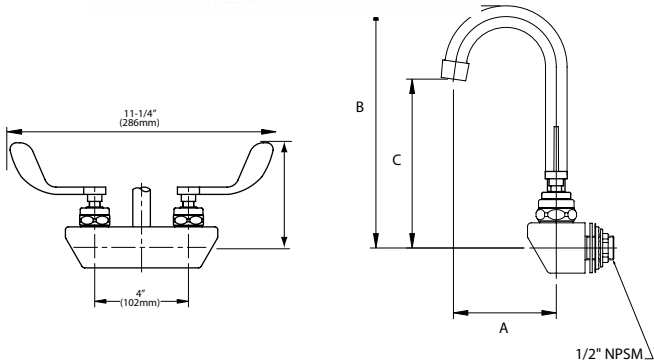

Dimensions shown in inches (mm) are for reference only and are subject to change.

1/2" NPSM Male Inlets

Operating Temperature: 40-180°F (5-83°C)

Operating Pressure: 15-125psi

Note: 1-1/8" (29mm) holes for deck and backsplash are recommended to accommodate 1/2" supply nipples

Approximate shipping weight - 5 lbs

Warranty - 2 years parts

Solid heavy duty cast body is specification and commercial quality for hand sinks.

Commercial Quality Features

- Rigid gooseneck spout design
- ADA-compliant 4" (102mm) wrist blade handles
- Built-in check valves to prevent cross-flow and back-flow
- Stainless steel spout

SPECIFICATIONS:

Wall Mount Faucet to be Encore KL45 Series in the following configuration:

- ___ KL45-4100-RE4 3" Spout, Ceramic Valves
- ___ KL45-4000-RE4 3" Spout, Compression Valves
- ___ KL45-4102-RE4 6" Spout, Ceramic Valves
- ___ KL45-4002-RE4 6" Spout, Compression Valves
- ___ KL45-4101-RE4 8" Spout, Ceramic Valves
- ___ KL45-4001-RE4 8" Spout, Compression Valves

Faucet body to be constructed of polished chrome plated brass with 4" wrist blade handles. Supply inlets to be 4" on center. Valves to be 1/4-turn with integral check valve to prevent cross-flow and back-flow. Spout to be stainless steel rigid gooseneck style. Color coded temperature indexes shall meet international standards. 2.2gpm aerator @ 60psi standard with full flow stream bubbler screen spout tip.

Model No.	A	B	C
KL45-4100-RE4	3-1/2" (89mm)	8-3/4" (222mm)	5-3/8" (162mm)
KL45-4000-RE4	3-1/2" (89mm)	8-3/4" (222mm)	5-3/8" (162mm)
KL45-4102-RE4	6" (152mm)	9-3/4" (248mm)	6" (152mm)
KL45-4002-RE4	6" (152mm)	9-3/4" (248mm)	6" (152mm)
KL45-4101-RE4	8-1/2" (216mm)	12-3/4" (324mm)	7" (178mm)
KL45-4001-RE4	8-1/2" (216mm)	12-3/4" (324mm)	7" (178mm)

For a complete list of available options for KL45-4000 Series, see product configurator on reverse.

COMPLIES WITH:
 THE FEDERAL "REDUCTION OF LEAD IN DRINKING WATER ACT" -
 2011 - US SENATE BILL NO. S.3874
 NSF/ANSI 61/9, ANNEX G



Faucet Configuration for KL45-4000-R Series

