

PROJECT NAME: _____

LOCATION: _____

SPECIFIER ITEM NO. _____ **QTY:** _____

ENCORE PART NO. _____

Encore[®] Pre-Rinse Enclosed Hose
 Reel Assembly
KHR-5635-E(xx) Series

KHR-5635-E Red Powder Coated (*shown*)
 KHR-5635-ESS Stainless Steel



Hose reel is specification and commercial quality.

Commercial Quality Features

- Universal ceiling, floor or wall mount
- Heavy duty springs for hose recoil
- Positive latch for stationary hose operation
- 3.3gpm rinse spray with insulated handle and heavy duty face bumper

SPECIFICATIONS:

Pre-rinse open hose reel assembly to be Encore KHR-5635-E Series in the following configuration:

- _____ KHR-5635-E Red Powder Coated
- _____ KHR-5635-ESS Stainless Steel

Hose reel to be constructed of red powder coated steel or stainless steel. Hose to be 35' in length with stainless steel hose guard. Recoil bumper to be included.

Hose I.D.	Hose O.D.	Hose Length	Max Pressure*	(M)NPTF Hose Outlet	(F)NPTF Reel Inlet
3/8" (10mm)	.600" (15mm)	35' (11m)	300 psi (21 bar)	1/4"	3/8"

Maximum Temperature: 150°F (65°C)

*Maximum Working Pressure at 70°F (20°C)

DIMENSIONS:

A	B	C	D	E
14-3/8" (365mm)	14" (356mm)	9-3/4" (248mm)	2-1/2" (64mm)	6-1/8" (156mm)

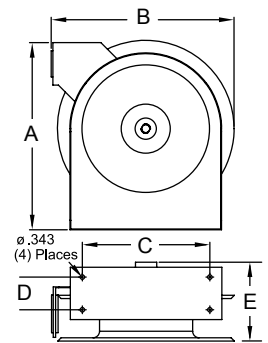

Dimensions shown in inches (mm) are for reference only and are subject to change.

Approximate shipping weight - 25 lbs
 Warranty - 1 year parts